

## PLASMA CUTTING

The new series of Torches  
with “**EASY FIT**”

A revolutionary solution to save time and money

Registered Community Design

**THE-105 75°**

**TME-105 180°**

**THE-125 75°**

**TME-125 180°**

**UPH-160 85° Hybrid**

**UPH-160 15° Hybrid**

**UPM-160 180° Hybrid**

**NEW**

**EASY FIT**  
Patent

● Higher performances

● Cleaner cut

● Faster speed

# EASY FIT

## Registered Community Design

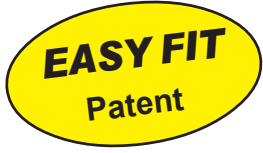

Hand Torch Head complete with Handle and parts

NEW

Machine Torch Head complete with support and parts

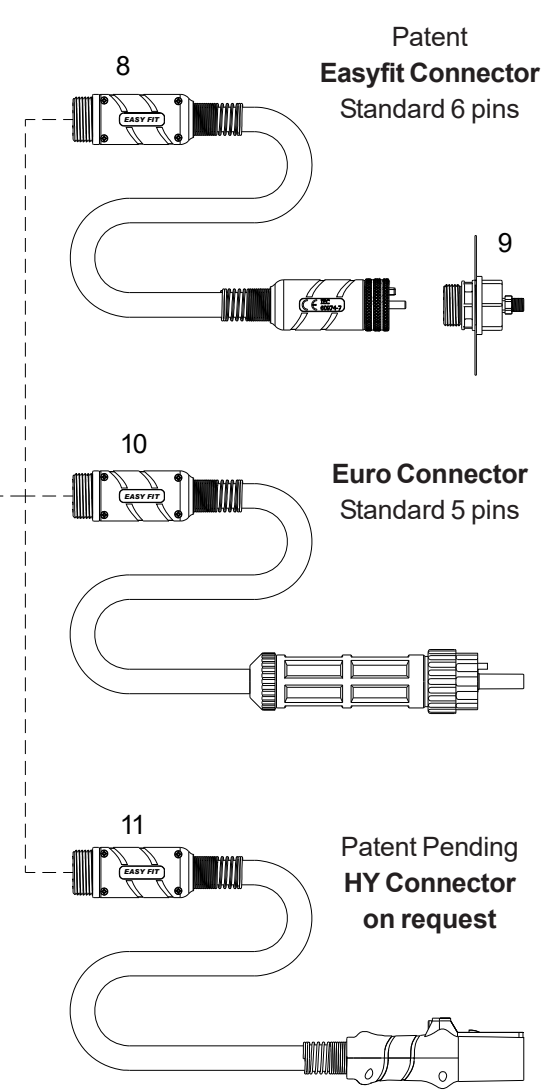
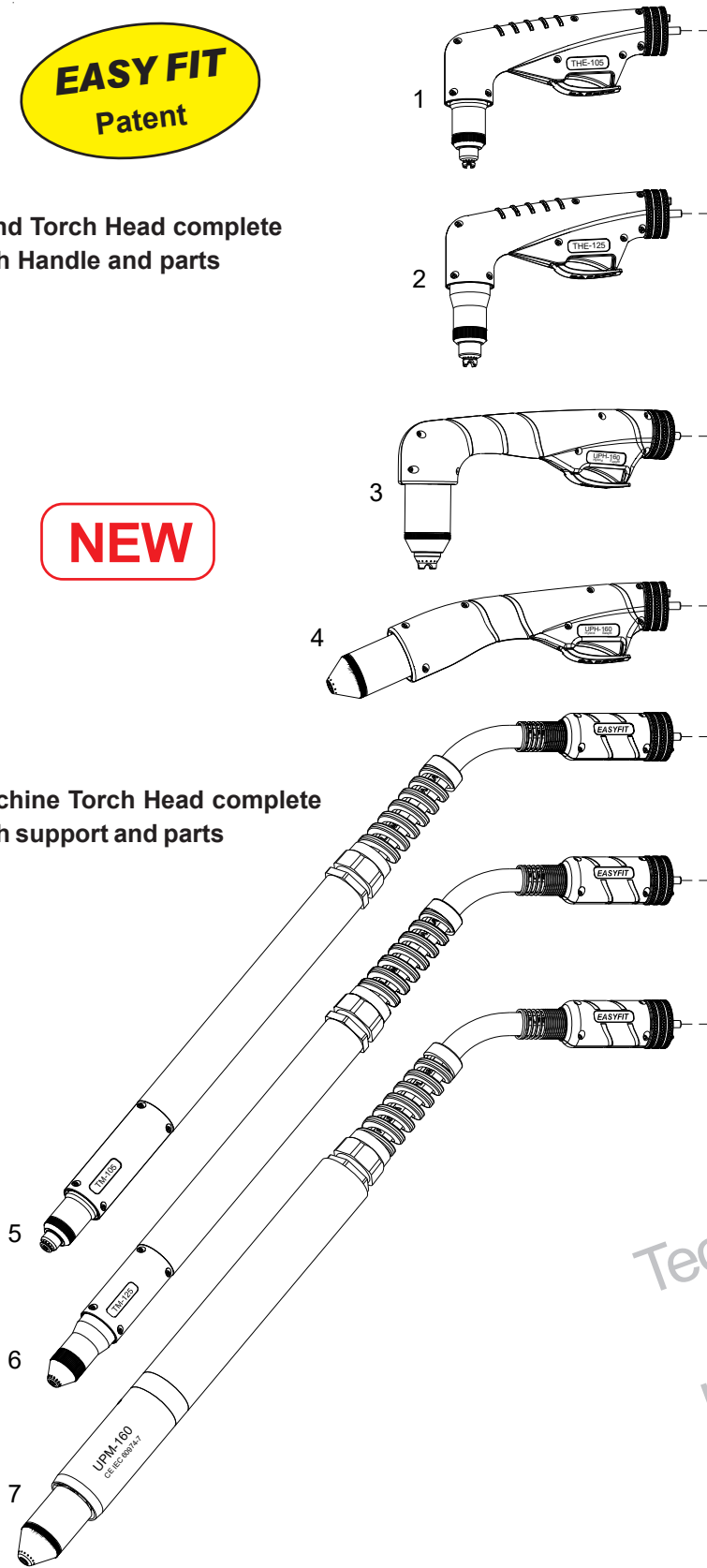

Technology & Innovation continue . . . .

**EASY FIT****Torches and Leads**

Item	Description	Code
1	<b>THE-105 eco</b> 75° Hand Torch Head <b>EASY FIT</b>	02100EE
	<b>THE-105</b> 75° Hand Torch Head <b>EASY FIT</b>	02100E
2	<b>THE-125 eco</b> 75° Hand Torch Head <b>EASY FIT</b>	03700EE
	<b>THE-125</b> 75° Hand Torch Head <b>EASY FIT</b>	03700E
3	<b>UPH-160</b> 85° Hand Torch Head <b>EASY FIT</b>	03900E
4	<b>UPH-160</b> 15° Hand Torch Head <b>EASY FIT</b>	03902E
5	<b>TME-105 eco</b> 180° Machine Torch Head <b>EASY FIT</b> ,	02110EE
	<b>TME-105</b> 180° Machine Torch Head <b>EASY FIT</b> ,	02110E
6	<b>TME-125 eco</b> 180° Machine Torch Head <b>EASY FIT</b>	03710EE
	<b>TME-125</b> 180° Machine Torch Head <b>EASY FIT</b>	03710E
7	<b>UPM-160</b> 180° Machine Torch Head <b>EASY FIT</b>	03910E
8	Lead Assembly, 6m (20 ft), <b>Coaxial Cable</b> , <b>EASY FIT</b> , 6 pins, <b>125A max</b>	05285FX
	Lead Assembly, 12m (40 ft), <b>Coaxial Cable</b> , <b>EASY FIT</b> , 6 pins, <b>125A max</b>	05287FX
	Lead Assembly, 6m (20 ft), <b>Coaxial Cable</b> , <b>EASY FIT</b> , 6 pins, <b>160A max</b>	05285FX-L
	Lead Assembly, 12m (40 ft), <b>Coaxial Cable</b> , <b>EASY FIT</b> , 6 pins, <b>160A max</b>	05287FX-L
9	<b>EASY FIT</b> Central Connection, Machine Side, 6 pins	05265
10	Lead Assembly, 6m (20 ft), <b>Coaxial Cable</b> , <b>Euro-Connector</b> , 5 pins, <b>125A max</b>	09781FX **
	Lead Assembly, 12m (40 ft), <b>Coaxial Cable</b> , <b>Euro-Connector</b> , 5 pins, <b>125A max</b>	09786FX **
	Lead Assembly, 6m (20 ft), <b>Coaxial Cable</b> , <b>Euro-Connector</b> , 5 pins, <b>160A max</b>	09781FX-L **
	Lead Assembly, 12m (40 ft), <b>Coaxial Cable</b> , <b>Euro-Connector</b> , 5 pins, <b>160A max</b>	09786FX-L **
11	Lead Assembly, with <b>HY Connector</b>	on request

\*\* Connection to the system to be confirmed on the purchase order

*Torches with different connectors available on request.*

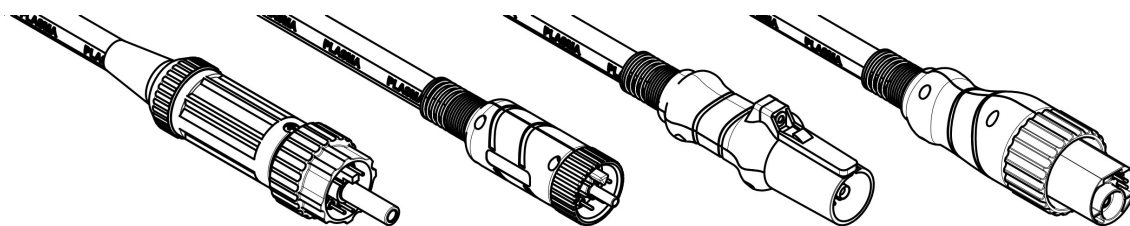

Connector  
**EURO**

Connector  
**EASYFIT**

Connector  
**HY**

Connector  
**TD**

PLASMA CUTTING TORCHES

**Technical Data**

Current: 20-105 Amps  
 Duty Cycle: 105 Amps 60%  
 Gas: Air/N2  
 Gas Pressure  
 - Cutting: 72-80 PSI (5.0-5.5 bar)  
 - Gouging: 50-65 PSI (3.5-4.5 bar)  
 Gas Flow at 105A: 510 scfh (240 lpm)  
 Post Flow Time : 45 sec  
 Pilot : Electrode to Tip (12-20A)  
 Ignition: Without HF

**For the correct operation please use:**  
 3-Ways Solenoid Valve, inside orifice  
 4.5-5.5mm - (0.178-0.217 inches)



Hand Torch Head complete with Handle and parts

**NEW**

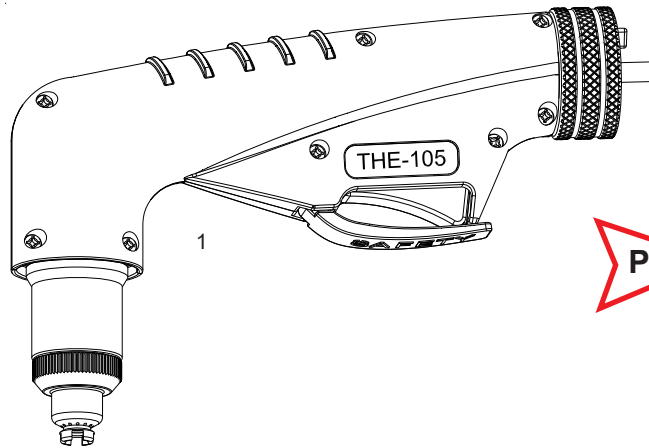

**Patent**

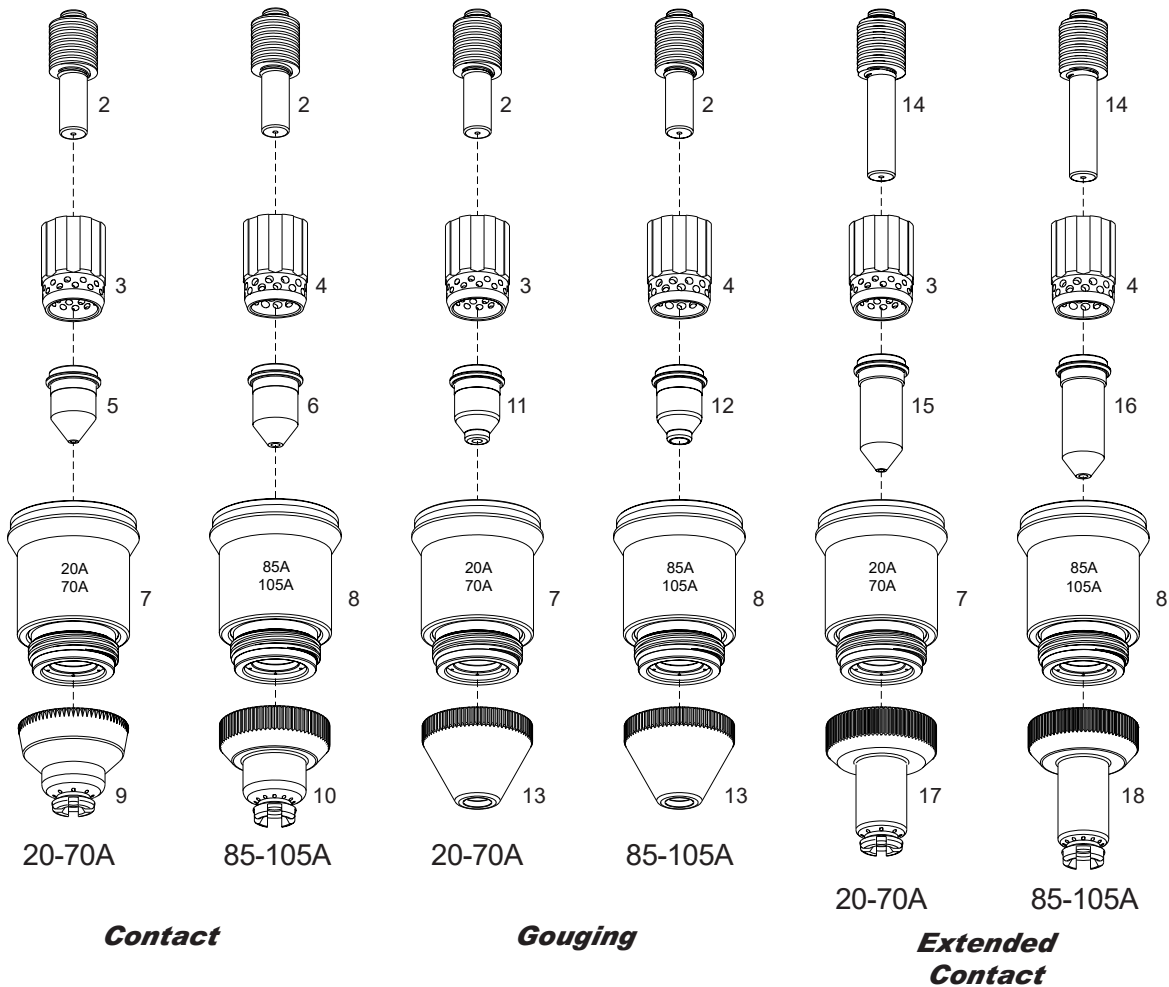

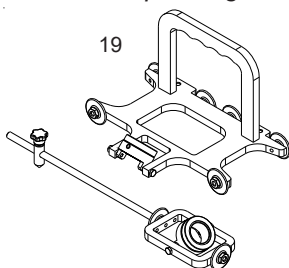
**Air or N<sub>2</sub>****THE-105eco**● **Standard Layout****THE-105**● **Standard Layout****Air Filter  
AT-1000****Bevel Tool**  
Patent pending**Replacement Parts****Torch parts**

Item	Description	Code
1 ●	<b>THE-105 eco</b> 75° Hand Torch Head <b>EASY FIT</b> .	02100EE
●	<b>THE-105</b> 75° Hand Torch Head <b>EASY FIT</b>	02100E
n/s	O-Ring	07300.60
2	Electrode, 20-105A	52574
3	Swirl ring, 20-70A <b>ECO</b>	60041E
	Swirl ring, 20-70A <b>Maximum Life</b>	60041
4 ●	Swirl ring, 85-105A <b>ECO</b>	60024E
●	Swirl ring, 85-105A <b>Maximum Life</b>	60024
5	Tip, Contact Cutting, 20-50A	51206
	Tip, Contact Cutting, 70A	51206.11
6	Tip, Contact Cutting, 85A	51223.13
● ●	Tip, Contact Cutting, 105A	51223.15
7	Shield Cup Body, 20-70A <b>ECO</b>	60305TE
	Shield Cup Body, 20-70A <b>Maximum Life</b>	60305T
8 ●	Shield Cup Body, 85-105A <b>ECO</b>	60329TE
●	Shield Cup Body, 85-105A <b>Maximum Life</b>	60329T
9	Shield Cap, 20-70A Hand	51923
10 ● ●	Shield Cap, 85-105A Hand	51941
11	Tip, Gouging, 45A	51206G
	Tip, Gouging, 70A	51206G.10
12	Tip, Gouging, 105A	51223G.14
13	Shield Cap, 20-105A Gouging	51924G
14	Extended Electrode, 20-105A	52574L
15	Extended Shielded Tip, Contact Cutting, 20-50A	51206L
	Extended Shielded Tip, Contact Cutting, 70A	51206L.11
16	Extended Shielded Tip, Contact Cutting, 85A	51223L.13
	Extended Shielded Tip, Contact Cutting, 105A	51223L.15
17	Extended Shield Cap, 20-70A Hand	51923L
18	Extended Shield Cap, 85-105A Hand	51941L

**Accessories**

Item	Description	Code
n/s	Circle Cutting Attachment	51865
19	BEVEL TOOL	51880

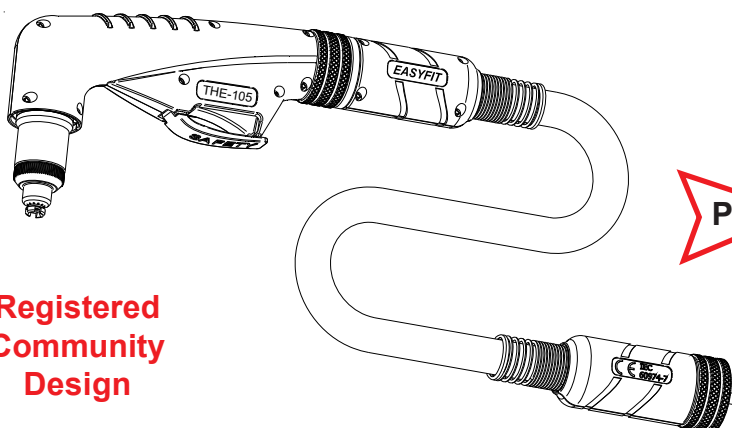
**Registered  
Community  
Design**

PLASMA CUTTING TORCHES

**Technical Data**

Current: 20-105 Amps  
 Duty Cycle: 105 Amps 60%  
 Gas: Air/N2  
 Gas Pressure  
 - Cutting: 72-80 PSI (5.0-5.5 bar)  
 - Gouging: 50-65 PSI (3.5-4.5 bar)  
 Gas Flow at 105A: 510 scfh (240 lpm)  
 Post Flow Time : 45 sec  
 Pilot : Electrode to Tip (12-20A)  
 Ignition: Without HF

**For the correct operation please use:**  
 3-Ways Solenoid Valve, inside orifice  
 3.5-4.0mm - (0.138-0.157 inches)



Machine Torch Head complete with support and parts

**NEW**

**Patent**

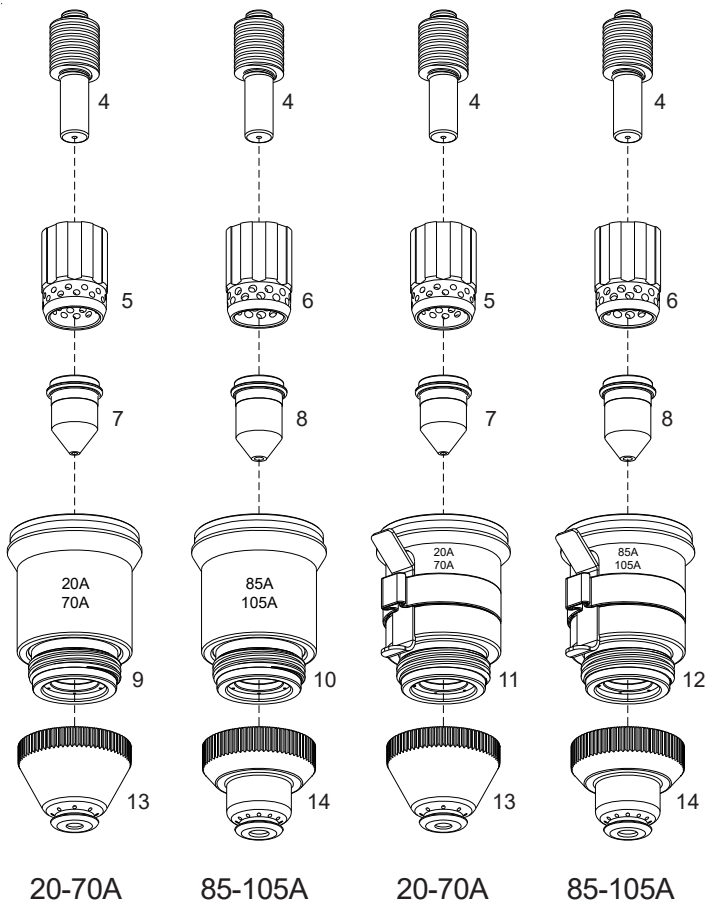

Shielded

Shielded with ohmic

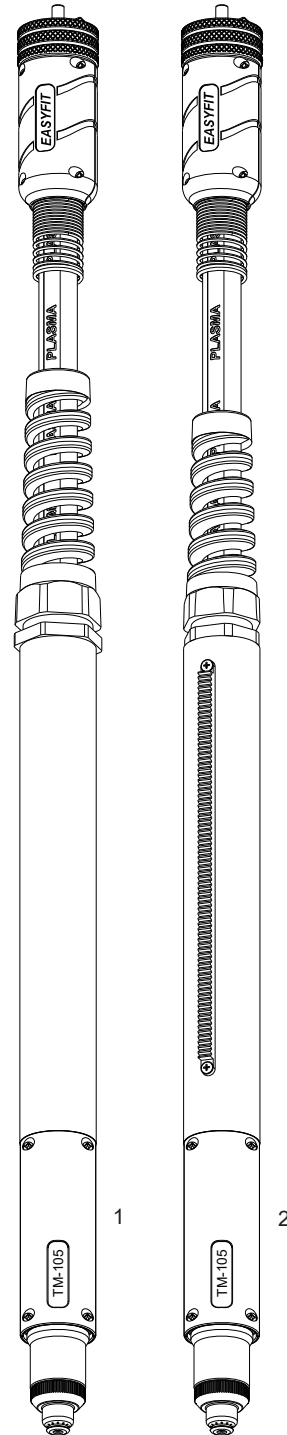

**Air or N<sub>2</sub>**

**TME-105eco**  
● Standard Layout

**TME-105**  
● Standard Layout

Air Filter  
**AT-1000**

**Replacement Parts****Torch parts**

Item	Description	Code
1 ●	<b>TME-105 eco</b> 180° Machine Torch Head <b>EASY FIT</b> ,	02110EE
●	<b>TME-105</b> 180° Machine Torch Head <b>EASY FIT</b> ,	02110E
2 ●	<b>TME-105 eco</b> 180° Machine Torch Head <b>EASY FIT</b> , w/rack	02112EE
●	<b>TME-105</b> 180° Machine Torch Head <b>EASY FIT</b> , w/rack	02112E
n/s	O-Ring	07300.60
1a	Fiberglass Positioning Tube	07218
2a	Fiberglass Positioning Tube With Rack	07219
4 ● ●	Electrode, 20-105A	52574
5	Swirl ring, 20-70A <b>ECO</b>	60041E
	Swirl ring, 20-70A <b>Maximum Life</b>	60041
6 ●	Swirl ring, 85-105A <b>ECO</b>	60024E
●	Swirl ring, 85-105A <b>Maximum Life</b>	60024
7	Tip, Contact Cutting, 20-50A	51206
	Tip, Contact Cutting, 70A	51206.11
8	Tip, Contact Cutting, 85A	51223.13
● ●	Tip, Contact Cutting, 105A	51223.15
9	Shield Cup Body, 20-70A <b>ECO</b>	60305TE
	Shield Cup Body, 20-70A <b>Maximum Life</b>	60305T
10 ●	Shield Cup Body, 85-105A <b>ECO</b>	60329TE
●	Shield Cup Body, 85-105A <b>Maximum Life</b>	60329T
11	Shield Cup Body <b>Ohmic</b> , 20-70A <b>ECO</b>	60305THE
	Shield Cup Body <b>Ohmic</b> , 20-70A <b>Maximum Life</b>	60305TH
12	Shield Cup Body <b>Ohmic</b> , 85-105A <b>ECO</b>	60329THE
	Shield Cup Body <b>Ohmic</b> , 85-105A <b>Maximum Life</b>	60329TH
13	Shield Cap, 20-70A Machine	51924
14 ● ●	Shield Cap, 85-105A Machine	51942

**Registered  
Community  
Design**

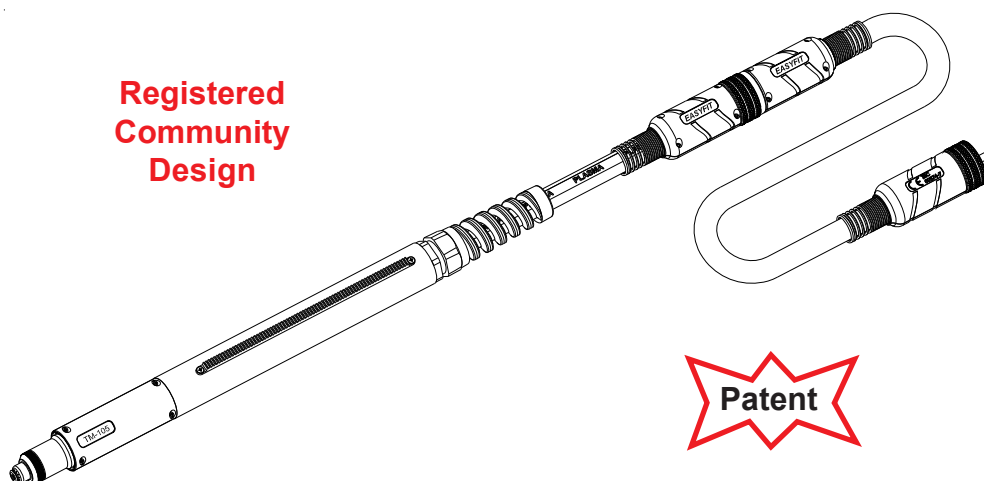

**Patent**

PLASMA CUTTING TORCHES

**Technical Data**

Current : 40-150 Amps  
 Duty Cycle: 125 Amps at 60%  
 150 Amps at 40%  
 Gas: Air/N2  
 Gas Pressure  
 - Cutting 125A: 72-87 PSI (5.0-6.0 bar)  
 - Cutting 150A: 80-87 PSI (5.5-6.0 bar)  
 - Gouging: 58-65 PSI (4.0-4.5 bar)  
 Gas Flow at 125A: 630 SCFH (295 lpm)  
 Post Flow Time : 45 sec  
 Pilot : Electrode to Tip (15-22A)  
 Ignition: Without HF

**For the correct operation please use:**  
 3-Ways Solenoid Valve, inside orifice  
 4.5-5.5mm - (0.178-0.217 inches)

**NEW**

CE IEC 60974-7

**Hand Torch Head complete with Handle and parts**

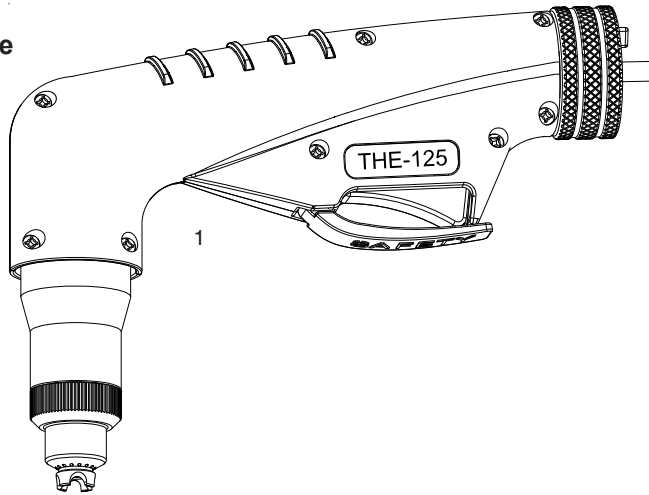

**Patent**

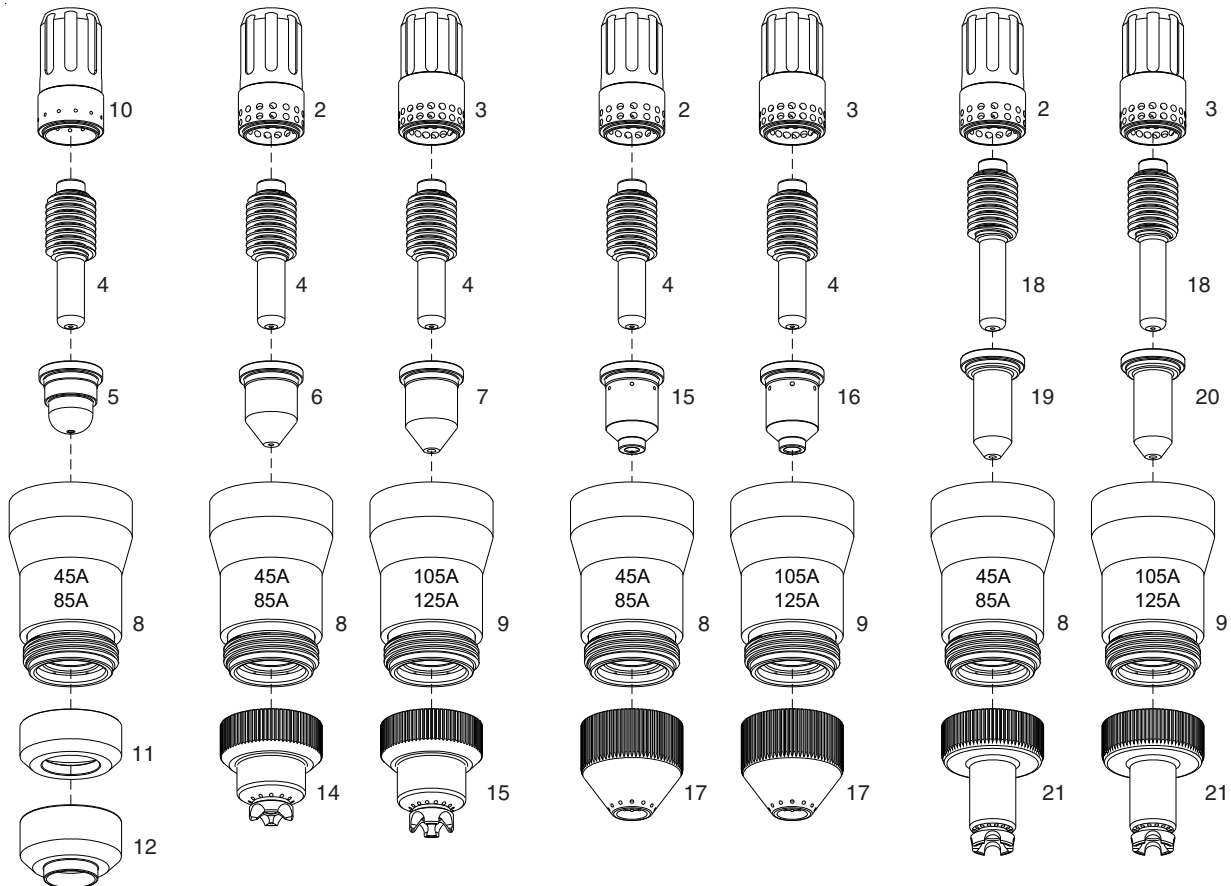

**45A Precision Cut**

**Contact**

**Gouging**

**Extended Contact**



**Air or N<sub>2</sub>**

**THE-125eco**  
● Standard Layout

**THE-125**  
● Standard Layout

Air Filter  
**AT-1000**

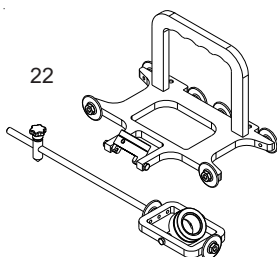

**Bevel Tool**  
Patent pending

**Replacement Parts****Torch parts**

Item	Description	Code
1 ●	<b>THE-125 eco</b> 75° Hand Torch Head <b>EASY FIT</b>	03700EE
	● <b>THE-125</b> 75° Hand Torch Head <b>EASY FIT</b>	03700E
n/s	O-Ring	03700.60
2	Swirl ring, 45-85A <b>ECO</b>	60042E
	Swirl ring, 45-85A <b>Maximum Life</b>	60042
3 ●	Swirl ring, 100-125A <b>ECO</b>	60040E
	● Swirl ring, 100-125A <b>Maximum Life</b>	60040
4 ●	● Electrode, 45-125A	52677
	Electrode, 45-125A, <b>BiMetal</b>	52677BM
5	Tip, Cutting, 45A Precision Cut	51415
6	Tip, Cutting, 45A	51416
	Tip, Cutting, 65A	51417
	Tip, Cutting, 85A	51418
7	Tip, Cutting, 105A	51419
	● ● Tip, Cutting, 125A	51419.16
	Tip, Cutting, 150A	51419.18
8	Shield Cup Body, 45-85A <b>ECO</b>	60309EA
	Shield Cup Body, 45-85A <b>Maximum Life</b>	60309TA
9 ●	Shield Cup Body, 100-125A <b>ECO</b>	60309EC
	● Shield Cup Body, 100-125A <b>Maximum Life</b>	60309TC
10	Swirl ring, 45A, Precision Cut <b>Maximum Life</b>	60032
11	Deflector,	51928
12	Deflector, 45A Precision Cut	51931
13	Shield Cap, Hand, 45-85A	51921
14 ●	● Shield Cap, Hand, 100-125A	51926
15	Tip, Gouging, 65-85A	51417G
16	Tip, Gouging, 105A	51418G
	Tip, Gouging, 125A	51419G
17	Shield Cap, Gouging	51927G
18	Extended Electrode	52677L
19	Extended Tip, 65A	51417L.12
	Extended Tip, 85A	51417L.13
20	Extended Tip, 105A	51417L.15
	Extended Tip, 125A	51417L.17
21	Extended Shield 65-125A	51926L

**Accessories**

n/s	Circle Cutting Attachment	51865
22	BEVEL TOOL	51880

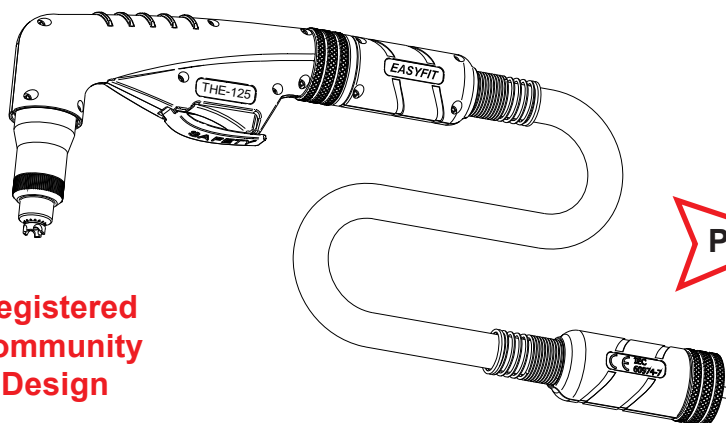

**Registered  
Community  
Design**

PLASMA CUTTING TORCHES

**Tecnical Data**

Current : 40-125 Amps  
 Duty Cycle: 125 Amps at 60%  
 Gas: Air/N2  
 Gas Pressure  
 - Cutting: 72-87 PSI (5.0-6.0 bar)  
 - Gouging: 58-65 PSI (4.0-4.5 bar)  
 Gas Flow at 125A: 630 SCFH (295 lpm)  
 Post Flow Time : 45 sec  
 Pilot : Electrode to Tip (15-22A)  
 Ignition: Without HF

**For the correct operation please use:**  
 3-Ways Solenoid Valve, inside orifice  
 4.5-5.5mm - (0.178-0.217 inches)



Machine Torch Head complete with support and parts



**NEW**

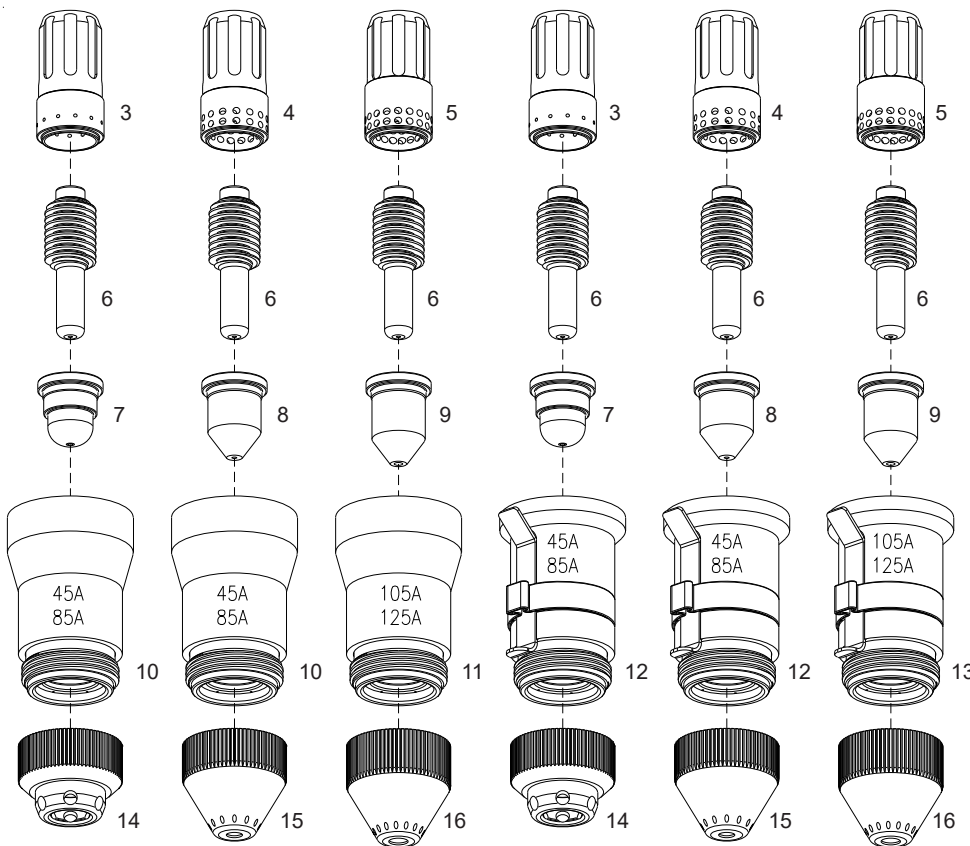

**Shielded**

**Shielded with ohmic**

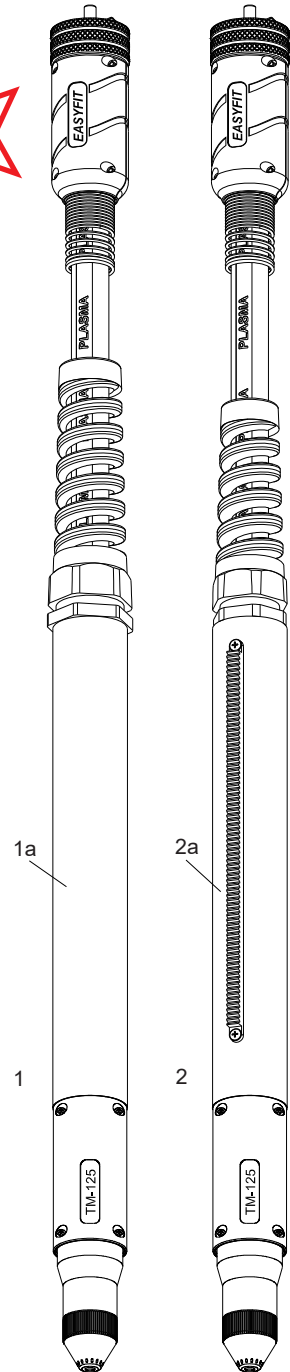

**Air or N<sub>2</sub>**

**TME-125eco**  
● **Standard Layout**

**TME-125**  
● **Standard Layout**

**Air Filter**  
**AT-1000**

**Replacement Parts****Torch parts**

Item	Description	Code
1 ●	<b>TME-125 eco</b> 180° Machine Torch Head <b>EASY FIT</b>	03710EE
	● <b>TME-125</b> 180° Machine Torch Head <b>EASY FIT</b>	03710E
2 ●	<b>TME-125 eco</b> 180° Machine Torch Head <b>EASY FIT</b> , w/rack	03712EE
	● <b>TME-125</b> 180° Machine Torch Head <b>EASY FIT</b> , w/rack	03712E
n/s	O-Ring	03700.60
1a	Fiberglass Positioning Tube	07218
2a	Fiberglass Positioning Tube With Rack	07219
3	Swirl ring, 45A, Precision Cut <b>Maximum Life</b>	60032
4	Swirl ring, 45-85A <b>ECO</b>	60042E
	Swirl ring, 45-85A <b>Maximum Life</b>	60042
5 ●	Swirl ring, 100-125A <b>ECO</b>	60040E
	● Swirl ring, 100-125A <b>Maximum Life</b>	60040
6 ●	● Electrode, 45-125A	52677
	Electrode, 45-125A, <b>BiMetal</b>	52677BM
7	Tip, Cutting, 45A Precision Cut	51415
8	Tip, Cutting, 45A	51416
	Tip, Cutting, 65A	51417
	Tip, Cutting, 85A	51418
9	Tip, Cutting, 105A	51419
	● ● Tip, Cutting, 125A	51419.16
10	Shield Cup Body, 45-85A <b>ECO</b>	60309EA
	Shield Cup Body, 45-85A <b>Maximum Life</b>	60309TA
11 ●	Shield Cup Body, 100-125A <b>ECO</b>	60309EC
	● Shield Cup Body, 100-125A <b>Maximum Life</b>	60309TC
12	Shield Cup Body, 45-85A <b>Ohmic</b>	60309THA
	Shield Cup Body, 45-85A <b>Ohmic ECO</b>	60309EHA
13	Shield Cup Body, 100-125A <b>Ohmic</b>	60309THC
	Shield Cup Body, 100-125A <b>Ohmic ECO</b>	60309EHC
14	Shield Cap, 45A Precision Cut	51929
15	Shield Cap, Machine, 45-85A	51922
16 ●	● Shield Cap, Machine, 100-125A	51927

**Registered**  
**Community**  
**Design**

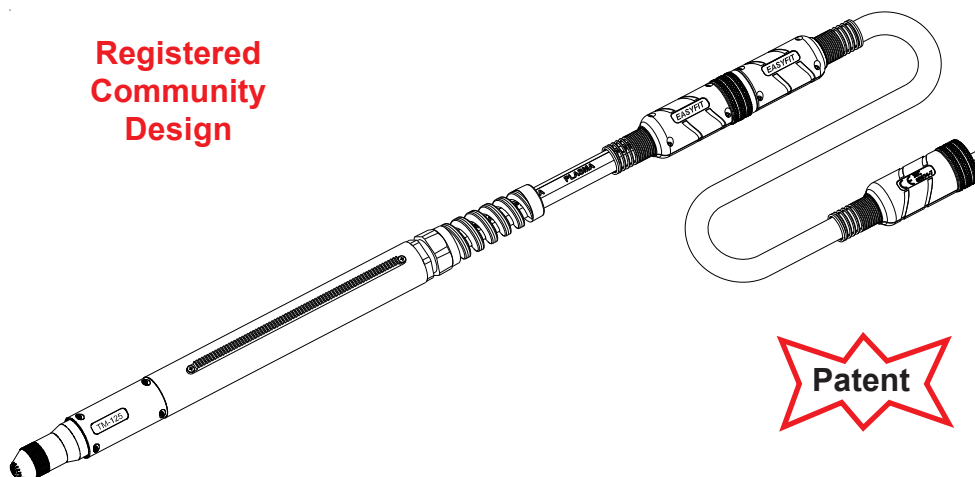

35+  
Years

**TEC.MO.**®

PLASMA CUTTING TORCHES

# UPH-160

## Hybrid with **EASY FIT**

**Technical Data**

Current : 30-160 Amps  
 Duty Cycle: 160 Amps at 60%  
 Gas: Air/N2  
 Gas Pressure  
 - Cutting: 72-87 PSI (5.0-6.0 bar)  
 - Gouging: 40-46 PSI (3.0-3.5 bar)  
 Gas Flow at 160A: 850 SCFH (420 lpm)  
 Post Flow Time : 45 sec.  
 Pilot : Electrode to Tip (22-25)  
 Ignition: Without HF

**For the correct operation please use:**  
 3-Ways Solenoid Valve, inside orifice  
 4.5-5.5mm - (0.178-0.217 inches)

**NEW**

CE IEC 60974-7

**Hand Torch Head complete with Handle and Parts**

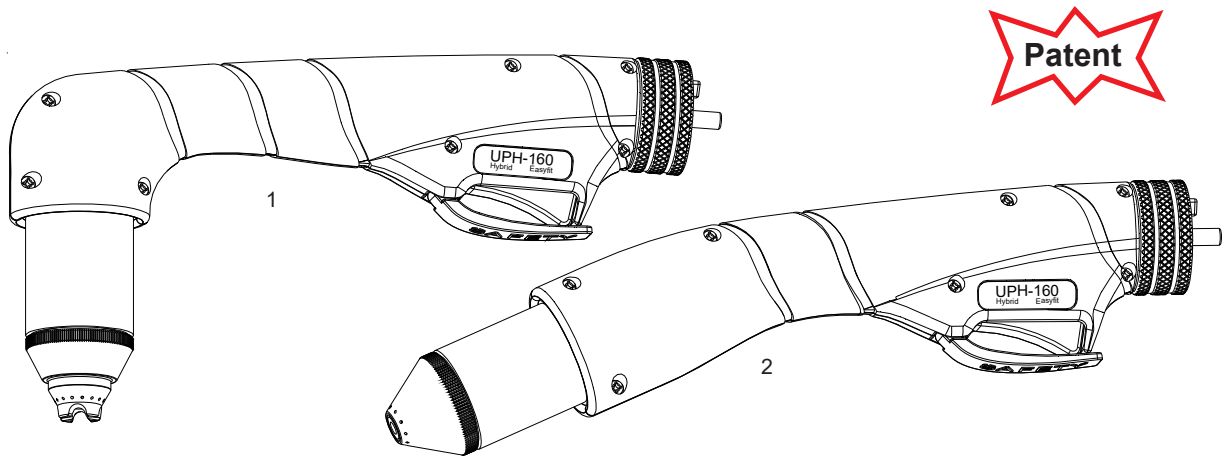

**Patent**

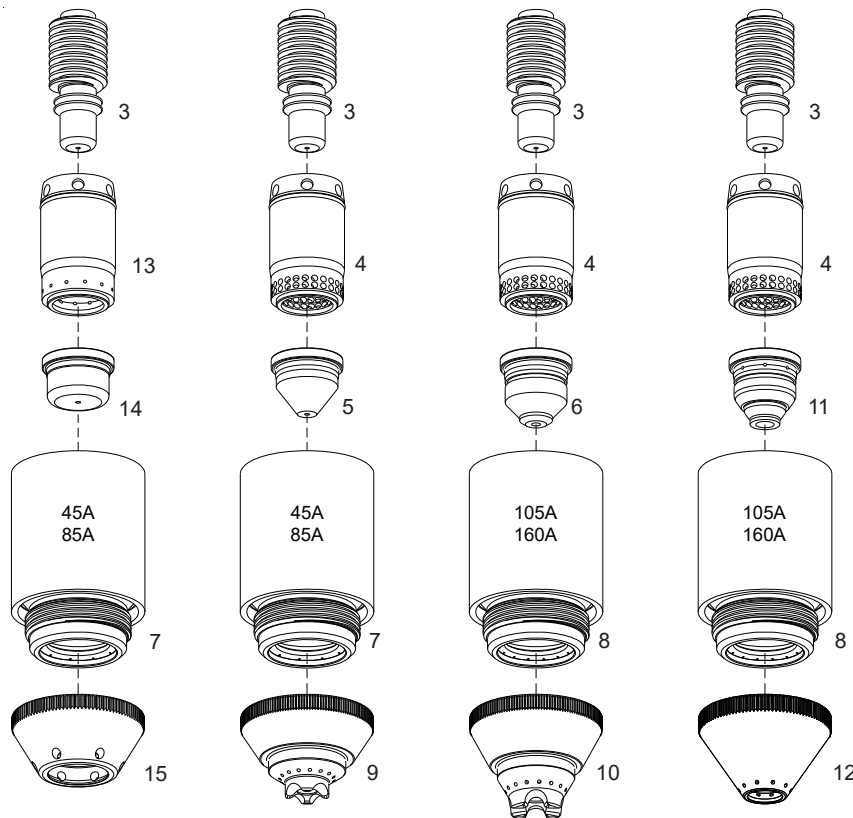

**Electrode Patent pending**

**Precision Cut**

**Contact**

**Gouging**

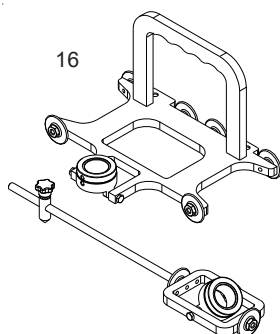
**Air or N<sub>2</sub>****UPH-160 85°****CUTTING**● **Standard Layout****UPH-160 15°****GOUGING**● **Standard Layout****Air Filter  
AT-1000****Bevel Tool  
Patent pending****Replacement Parts****Torch parts**

Item	Description	Code
1 ●	<b>UPH-160 85° Hand Torch Head EASY FIT</b>	03900E
2 ●	<b>UPH-160 15° Hand Torch Head EASY FIT</b>	03902E
3 ● ●	Electrode, <b>Patent Pending</b>	52678
	Electrode, <b>BiMetal, Patent Pending</b>	52678BM
4 ● ●	Swirl ring, <b>Maximum Life</b>	60039
	Swirl ring, <b>ECO</b>	60039E
5	Tip, Cutting, 45A	51420
	Tip, Cutting, 65A	51421
	Tip, Cutting, 85A	51422
6	Tip, Cutting, 105-125A	51425
●	Tip, Cutting, 160A	51426
7	Shield Cup Body, 45-85A	60311TA
8 ● ●	Shield Cup Body, 105-160A	60311TB
9	Shield Cap, Hand, 45-85A	51916T
10 ●	Shield Cap, Hand, 105-160A	51917T
11	Tip, Gouging, 105-125A	51424G
●	Tip, Gouging, 160A	51425G
12 ●	Shield Cap, Gouging	51919G
13	Swirl ring, Precision Cut (Hand Cutting)	60033
14	Tip, 30-45A, Precision Cut	51428
15	Deflector, Precision Cut	51915

**Accessories**

n/s	Circle Cutting Attachment	51868
16	BEVEL TOOL	51886

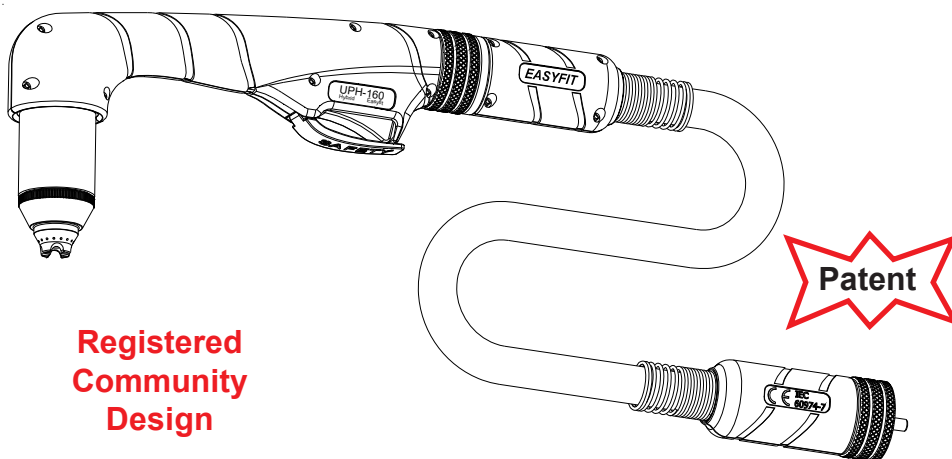
**Registered  
Community  
Design**

# UPM-160

## Hybrid with EASY FIT

PLASMA CUTTING TORCHES

**Technical Data**

Current :	30-160 Amps
Duty Cycle:	160 Amps at 60%
Gas:	Air/N2
Gas Pressure	
- Cutting:	72-87 PSI (5.0-6.0 bar)
- Gouging:	40-46 PSI (3.0-3.5 bar)
Gas Flow at 160A:	850 SCFH (420 lpm)
Post Flow Time :	45 sec.
Pilot :	Electrode to Tip (22-25)
Ignition:	Without HF

Machine Torch Head complete with Support and Parts



*Electrode Patent pending*

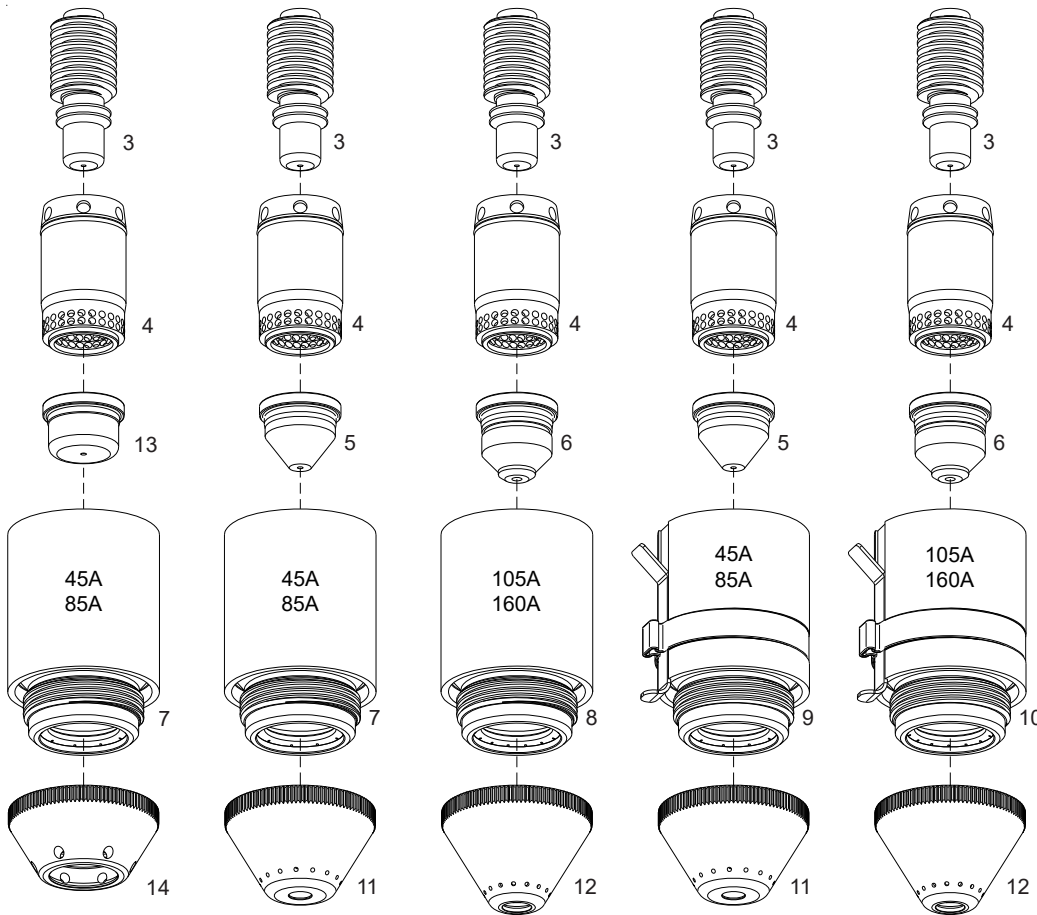

**Precision Cut**

**Shielded**

**Shielded with ohmic**

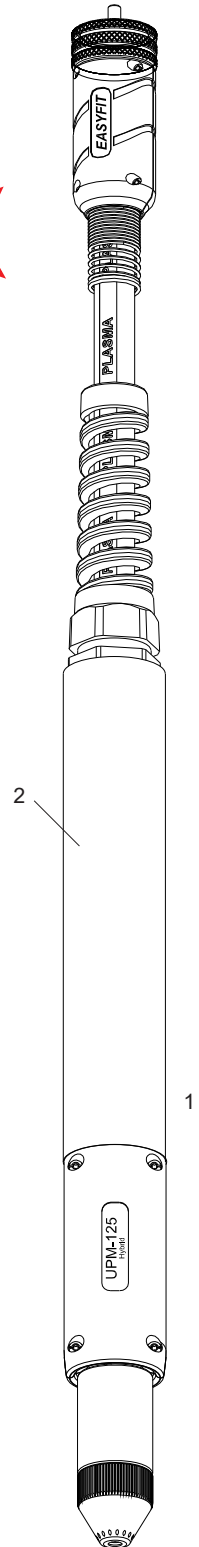

**Air or N<sub>2</sub>****UPM-160**  
● **Standard Layout****Air Filter**  
**AT-1000****Replacement Parts****Torch parts**

<i>Item</i>	<i>Description</i>	<i>Code</i>
1	● <b>UPM-160</b> 180° Machine Torch Head <b>EASY FIT</b>	03910E
2	● Fiberglass Positioning Tube	03916
3	● Electrode <b>Patent Pending</b>	52678
	Electrode, <b>BiMetal</b> , <b>Patent Pending</b>	52678BM
4	● Swirl ring, <b>Maximum Life</b>	60039
	Swirl ring, <b>ECO</b>	60039E
5	Tip, Cutting, 45A	51420
	Tip, Cutting, 65A	51421
	Tip, Cutting, 85A	51422
6	Tip, Cutting, 105-125A	51425
	● Tip, Cutting, 160A	51426
7	Shield Cup Body, 45-85A	60311TA
8	● Shield Cup Body, 105-160A	60311TB
9	Shield Cup Body, 45-85A <b>Ohmic</b>	60311THA
10	Shield Cup Body, 105-160A <b>Ohmic</b>	60311THB
11	Shield Cap, Machine, 45-85A	51918T
12	● Shield Cap, Machine, 105-160A	51919T
13	Tip, 30-45A, Precision Cut	51428
14	Deflector, Precision Cut	51915

**Registered  
Community  
Design**

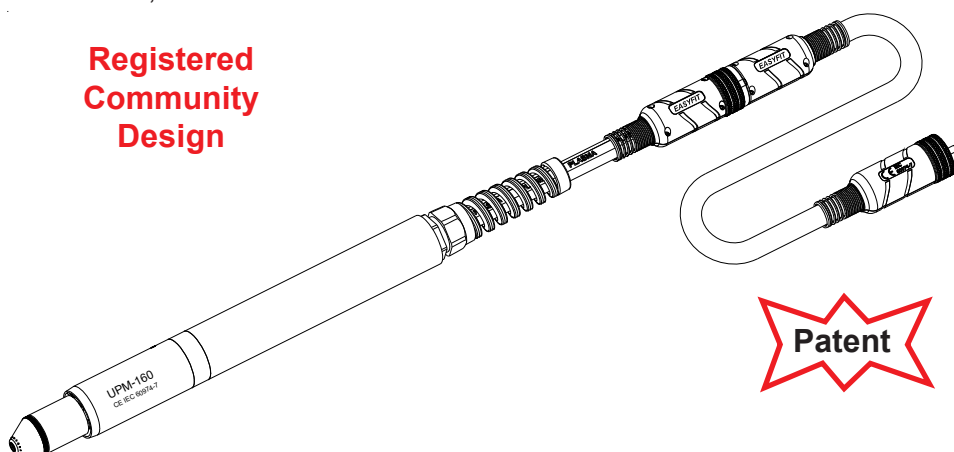

**EASY FIT** Connector

Registered Community Design

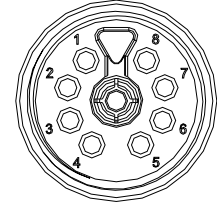
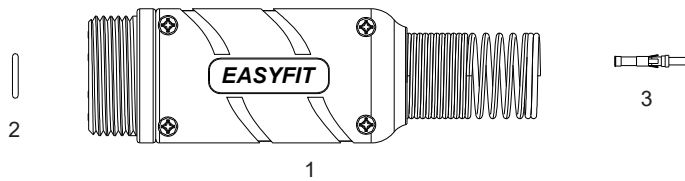
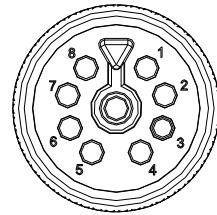
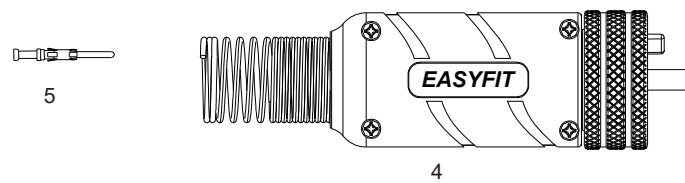
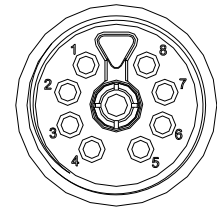
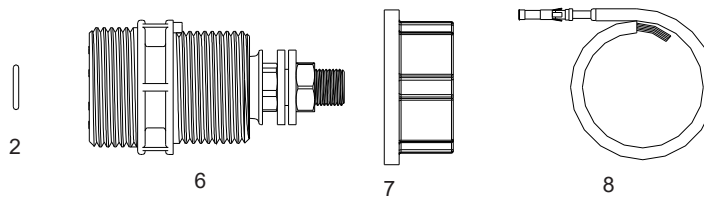
**EASY FIT**  
Patent**Torch side  
FEMALE****Torch side  
MALE****Machine side  
FEMALE**

Item	Description	Code
1	Complete KIT <b>Easyfit Female</b> - for cables with crimped connection	05266RPT
2	O-Ring - (conf.20 pcs)	20850.41
3	Contact pin female - (conf.10 pcs)	05265.45
4	Complete KIT <b>Easyfit Male</b> - for cables with crimped connection	05261RPT
5	Contact pin male - (conf.10 pcs)	05260.45
6	<b>Machine connector Easyfit</b> ( standard connection 6 pins )	05265
	<b>Machine connector Easyfit</b> ( connection 7 pins )	05265-7
	<b>Machine connector Easyfit</b> ( connection 8 pins )	05265-8
7	Hexagonal Nut	04265.41
8	Contact pin, <b>BLACK</b> lead, 0.75mm <sup>2</sup> x 600mm	04265.21
	Contact pin, <b>RED</b> lead, 0.75mm <sup>2</sup> x 600mm	04265.22
	Contact pin, <b>BLUE</b> lead, 0.75mm <sup>2</sup> x 600mm	04265.23
	Contact pin, <b>BROWN</b> lead, 0.75mm <sup>2</sup> x 600mm	04265.24
	Contact pin, <b>WHITE</b> lead, 0.75mm <sup>2</sup> x 600mm	04265.25



## PLASMA CUTTING TORCHES

## AIR FILTER AT1000

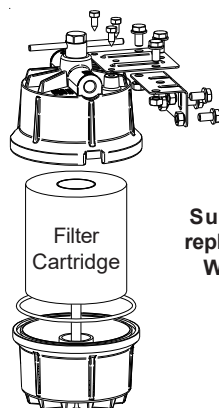

**Suggested  
replacement:  
WEEKLY**

Air Filter Complete Code: 50500

**Packaging:**

Air Filter AT1000

Code: 50500-12

Carton Box: 12 Filters

Dimensions: 11" x 16.5" x h. 17.3"  
(cm 28 x 42 x h. 44)

Weight: 43 lbs ( 19.5 kg )

-----  
**Filter Cartridge**

Code: 50505-8

Carton Box: 8 Cartridges

Dimensions: 8.58" x 8.58" x h. 9.61"  
(cm 21.8 x 21.8 x h. 24.4)

Weight: 4.2 lbs ( 1.9 kg )

Code: 50505-48

Master Box: 8x6=48 Cartridges

Dimensions: 17.72" x 26.38" x h. 10.43"  
(cm 45 x 67 x h. 26.5)

Weight: 26.7 lbs ( 12.1 kg )

"AT 1000" is the perfect solution to the problems created by the contamination of the compressed air used in many plasma cutting systems.

It eliminates "sputter" caused by moisture and oil from compressed air lines.

It extends the electrode and nozzle life, with obvious benefits to the cut quality.

Designed to remove aerosol oil and moisture, "AT 1000" is a real benefit, entrapping particles as small as .01 microns inches.

With "AT 1000" torches last longer. Without this filter, at the end of this cutting session, inside the torch and torch head you have left condensed moisture, that can cause a short-circuit, with consequent rise of costs coming from the replacement of the torch head and the needed time to realize this operation.

"AT 1000" can filter up to 1250 liters a minute without reduction in pressure.

It's recommended to replace the filter cartridge every 5 to 7 days (max).

It's also very suitable for painters and use of pneumatic tools.

Our excellent knowhow in the production of plasma cutting torches and the consequent problems of air contaminant brought us to create the "AT 1000" being very effective and important for users of plasma cutting systems.

---

## BEVEL TOOL

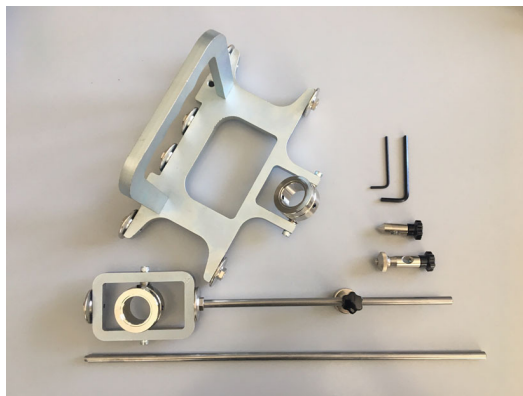

Code	Description
51880	TEC.MO.® THE-105/125
51886	TEC.MO.® UPH-160

**35+**  
years

**TEC.MO.**  
=

Quality  
Technology  
Innovation